

PS.7600SA

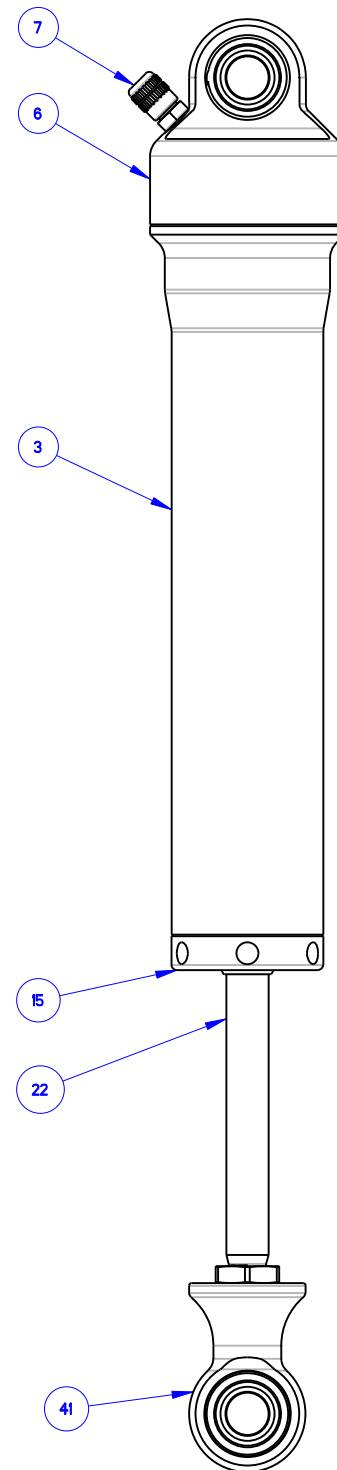
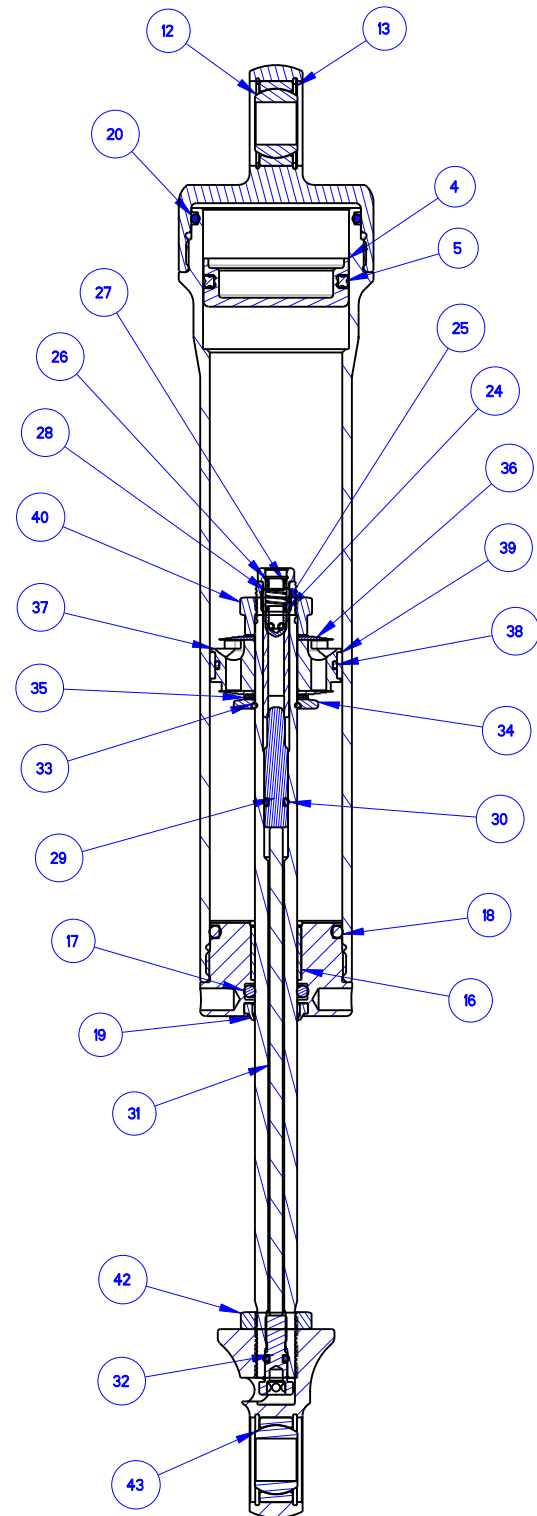

| NO. | DRAWING # | DESCRIPTION | QTTY |
|-----|------------------|--------------------------------|------|
| 1 | PS.7600SA | | 1 |
| 2 | AS.7600.BODY.6. | | 1 |
| 3 | BD.766 | BODY,7600 | 1 |
| 4 | PI.75 | FLOATING PISTON, 7500 | 1 |
| 5 | OR.4221.B | QUAD-RING | 1 |
| 6 | BC.75TV | BODY CAP | 1 |
| 7 | AS.IU22COMPLETE. | INFLATION UNIT | 1 |
| 8 | IU.22.S. | AIR VALVE, PORT O-RING, S.S. | 1 |
| 9 | IU.04 | STANDARD VALVE CORE | 1 |
| 10 | IU.06 | INFLATION VALVE CAP | 1 |
| 11 | OR.2010.B | O-RING | 1 |
| 12 | MO.8T | MONO BALL | 1 |
| 13 | RR.16 | RETAINING RING | 2 |
| 14 | AS.7600.TH.SB. | | 1 |
| 15 | SB.76TH | SHAFT BEARING | 1 |
| 16 | BU.08DU10 | BUSHING | 1 |
| 17 | OR.2206.B | O-RING | 1 |
| 18 | OR.2219.B | O-RING | 1 |
| 19 | SL.06 | SEAL | 1 |
| 20 | OR.2133.B | O-RING | 1 |
| 21 | AS.7600.SHAFT.6. | | 1 |
| 22 | SH.76A6 | SHAFT | 1 |
| 23 | JT.76RD | ASSB, JET, 8760 REB ADJ | 1 |
| 24 | JT.RDHSNG | JET HOUSING, 8760 REB ADJ | 1 |
| 25 | JT.76POP | JET, POPPET | 1 |
| 26 | RR.05 | RETAINING RING, .250" INTERNAL | 1 |
| 27 | JT.76HAT | JET, TOP HAT | 1 |
| 28 | SP.15.INSTALLED | SPRING, (FF71) | 1 |
| 29 | NE.76 | NEEDLE, 8760 | 1 |
| 30 | OR.2007.B | O-RING | 2 |
| 31 | MR.7600.6. | METERING ROD | 1 |
| 32 | RS.7600 | REBOUND SCREW, 7600 | 1 |
| 33 | RR.07 | RETAINING RING | 1 |
| 34 | VW.7600 | TOP OUT PLATE | 1 |
| 35 | VW.00.750.X.20 | RETURN SHIM | 4 |
| 36 | VS.C | VALVE STACK | 2 |
| 37 | PI.11004 | 45mm 1/1 PISTON | 1 |
| 38 | OR.2025.B | O-RING | 1 |
| 39 | PB.45 | PISTON BAND | 1 |
| 40 | NT.02R | SHAFT NUT | 1 |
| 41 | EY.76150.CO | EYELET | 1 |
| 42 | NT.14J | LOCK NUT, .500 | 1 |
| 43 | MO.8T | MONO BALL | 1 |

| REVISIONS | | THIRD ANGLE PROJECTION | DO NOT SCALE | IF IN DOUBT - ASK |
|---|-------|---|---------------------|---------------------------|
| 1 | ISSUE | 8/7/07 | | |
| | | <p>PENSKIE RACING SHOCKS 150 FRANKLIN STREET, READING, PA. 19602 U.S.A. (610) 375-0850 FAX</p> | | |
| TOLERANCES U.S. | | DESIGNED BY: GRR | CHECKED/PEA BY: JMA | ISSUE DATE: 8/7/07 |
| FRAC. ± 1/32 | | MATERIAL: | MACH. FINISH: 32 | FINISH/PROTECTION: |
| .XX ± .010 .XXX ± .005 .XXXX ± .001 | | TITLE: 7600 SERIES SINGLE ADJUSTABLE | | |
| ANG. ± 1/2° | | SCALE: 0.750 | SHEET: 1 OF: 1 | DRAWING NUMBER: PS.7600SA |